

'MASTERS' • SEPT. 5-9, 2018

EQUI-FAIR and the SHOPS

The Spruce Meadows 'Masters' attracts athletes and fans from around the world. The average attendance on market (5) days during the 'Masters' Tournament in 2017 was 225,595.

174 booths available in the Horizons Pavilion and Equi-Plex.

12 Höcker tents and outdoor space.

Event Space starting at just **\$880!**

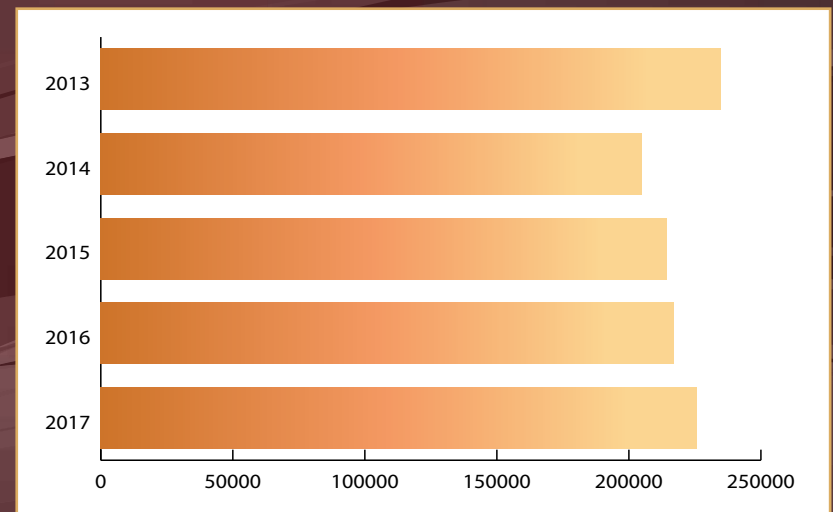

Average Event Attendance Chart (past 5 years)



'MASTERS' • SEPTEMBER 5-9, 2018 EQUI-FAIR and the SHOPS

HORIZONS PAVILION

The Horizons Pavilion can accommodate 46 draped booths in a large, light environment. The Horizons Pavilion is centrally located to provide maximum exposure for all vendors.

** Please be aware that the exhibit and booth layouts of this venue may change without notice and booth preference cannot be guaranteed. The floor plan shown here is proposed with the best information at hand at time of publication. Spruce Meadows reserves the right to change, without notice, the floor layout as registrations, building code and aesthetics dictate.*

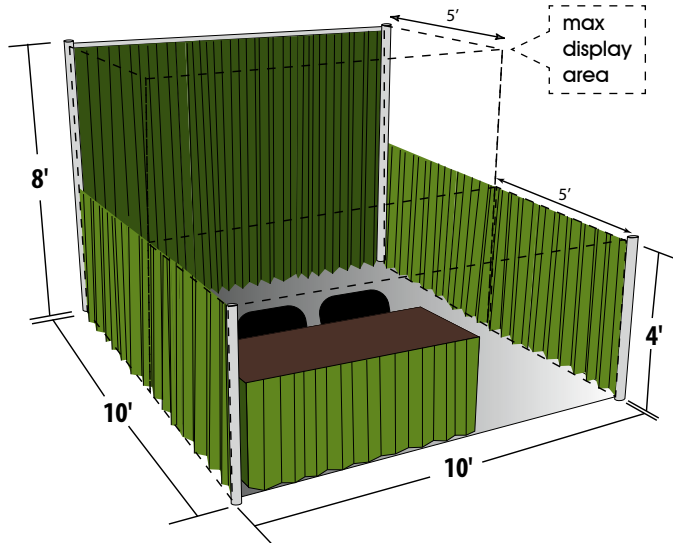
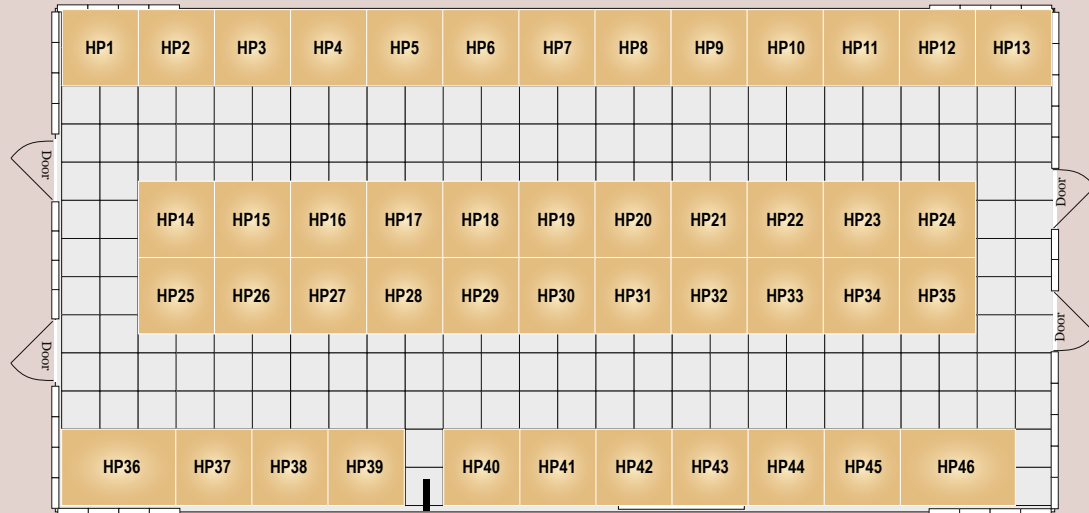

DRAPED BOOTH • \$1,100

Horizons Pavilion & Equi-Plex

(1) - 10' x 10' draped booth

(1) - Skirted 2' x 8' Table

(1) - 1,000 watt,

110 VAC Outlet

(1) - 8' x 1' Sign

(2) - Chairs

Prices do not include administration fee and 5% G.S.T.



IMPORTANT INFORMATION

All food vendors are limited to pre-packaged sales and sampling only.

Please be aware that sub-letting of booth space is absolutely NOT allowed.

Spruce Meadows has a very strict rule regarding sight lines within all venues. Vendors are not permitted to block, in any way, sight lines along aisles. Any vendor disrespecting this rule will be asked to remove all product displayed in this area.

'MASTERS' • SEPTEMBER 5-9, 2018 EQUI-FAIR and the SHOPS

A UNIQUE OPPORTUNITY

Höcker Tent for the 'Masters' Exhibit dates. Fully enclosed 700 sq. ft. hexagonal structure that offers exceptional product display & flexibility. Three prime locations: Founders Plaza, Upper & Lower Plaza.

HÖCKER TENT • \$3,300

Max. Span Width: 10m

Max. Eave Height: 3m

Max. Square Footage: 700ft.

*Prices do not include
administration fee and 5% G.S.T.*



2018 marks the 35th year of the Spruce Meadows Equi-Fair. While there have been venue changes over the years, the one thing that has remained a constant is the high quality and variety of vendors. This exhibition has something for everyone; saddles to trailers, fencing to hot tubs, ATVs and art: we hope every possible service, product and interest will be catered to. This international fusion of vendors attracts thousands of visitors looking to be inspired and energized by the many facets of acreage, rural, and contemporary living.

With Spruce Meadows professionalism and vendor friendly exhibition halls, it promises to be an event not to be missed and of course, with a huge variety of vendors and the vast array of products and services they provide, it will be a **MUST** attend event for everyone. It is a business opportunity that every business owner should take advantage of.

'MASTERS' • SEPTEMBER 5-9, 2018 EQUI-FAIR and the SHOPS

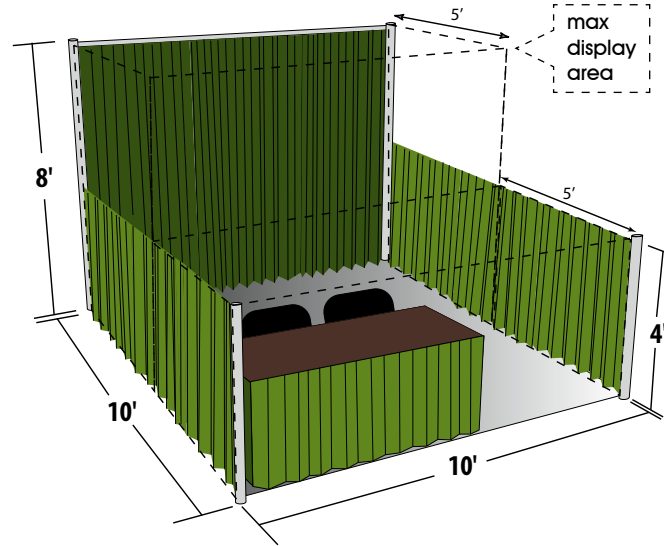
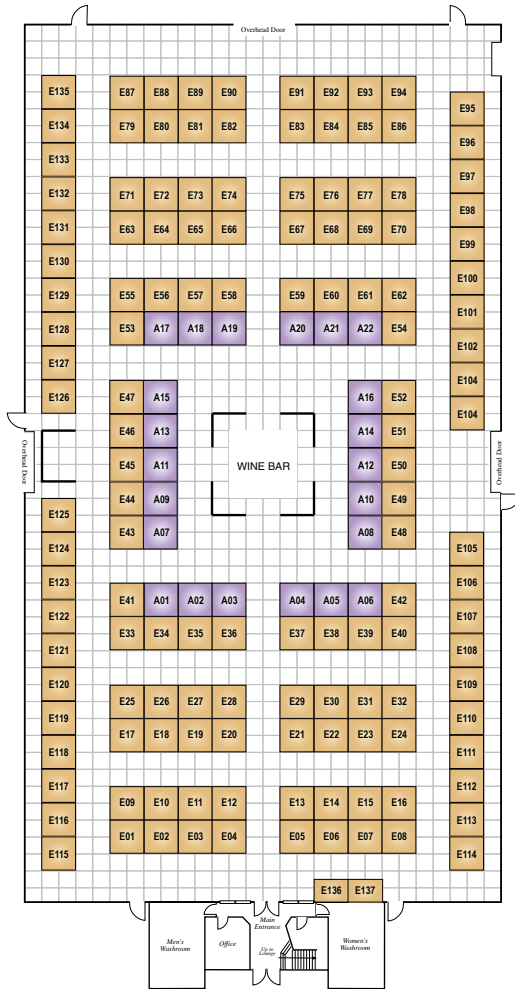

DRAPED BOOTH • \$1,100

Gallery on the Green & Equi-Plex

- (1) - 10' x 10' draped booth
- (1) - Skirted 2' x 8' Table
- (1) - 1,000 watt, 110 VAC Outlet
- (1) - 8' x 1' Sign
- (2) - Chairs

Prices do not include administration fee and 5% G.S.T.

ART BOOTH • \$880

Equi-Plex Only

Whether you're a fine artist, sculptor, photographer or contemporary artist, you will be able to showcase your finest works to an international audience in this designated area in the Equi-Plex.

- (1) - 10' x 10' draped booth
- (1) - Skirted 2' x 8' Table
- (1) - 1,000 watt, 110 VAC Outlet
- (1) - 8' x 1' Sign (2) - Chairs

Prices do not include administration fee and 5% G.S.T.

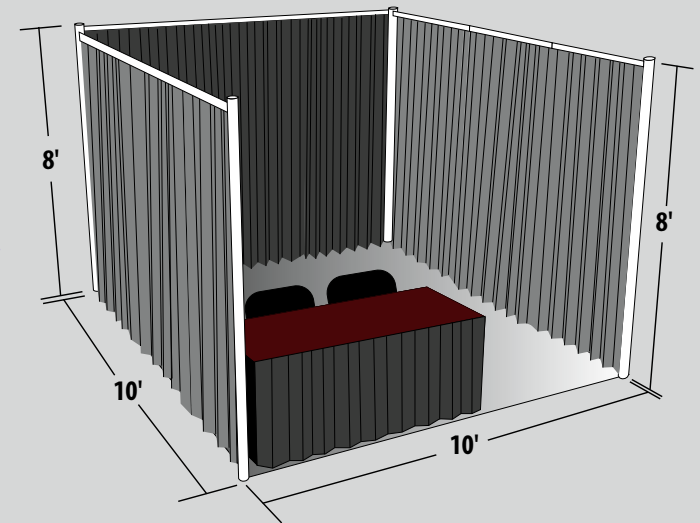

With approximately 36,000 square feet, the Equi-Plex is large enough to host a variety of vendors.

Draped Booth Art Exhibit (Art Booth)

'MASTERS' • SEPTEMBER 5-9, 2018 EQUI-FAIR and the SHOPS

OUTDOOR EXHIBIT SPACE STARTING FROM • \$990

No exhibit space is too big for Equi-Fair and The Shops at the 'Masters'. Products from trailers and stalls to hyperbaric chambers and boats can be accommodated in our outdoor areas. The feature outdoor exhibit spaces are located north of the Equi-Plex and in Founders Plaza. Limited premium space is also available at the south end of the Equi-plex on either side of the entrance.

The Exhibit Team is happy to provide you with all the necessary information to exhibit successfully during your stay at Spruce Meadows. We strive to help your enterprise establish strong business contacts in a unique, family friendly environment.

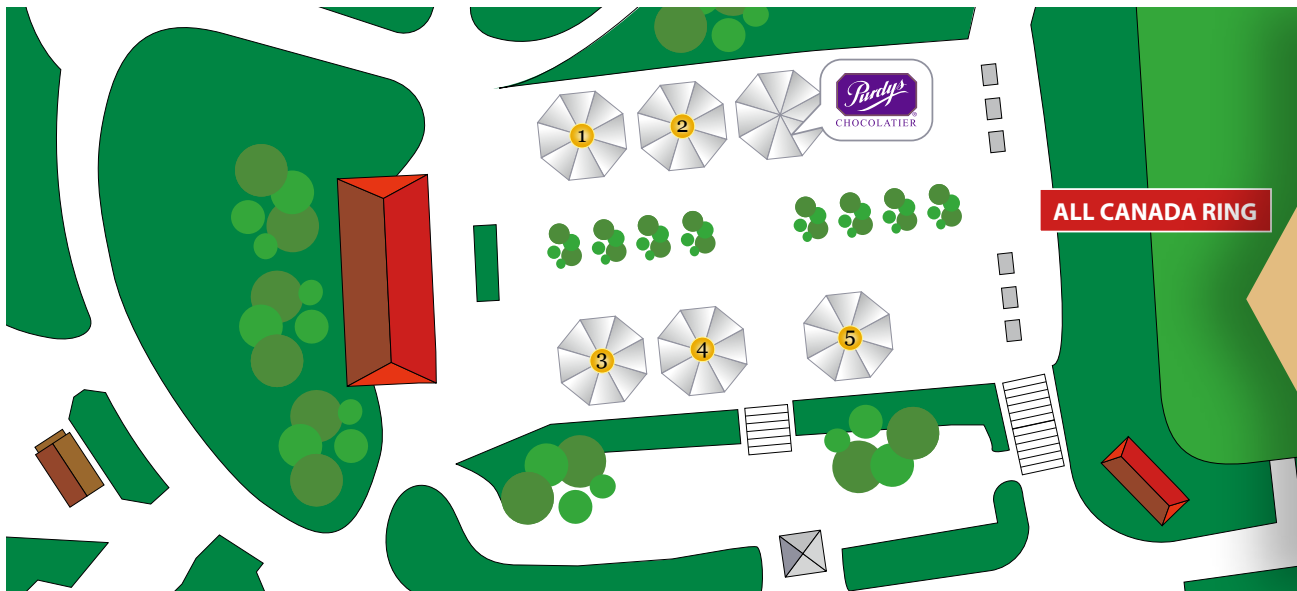
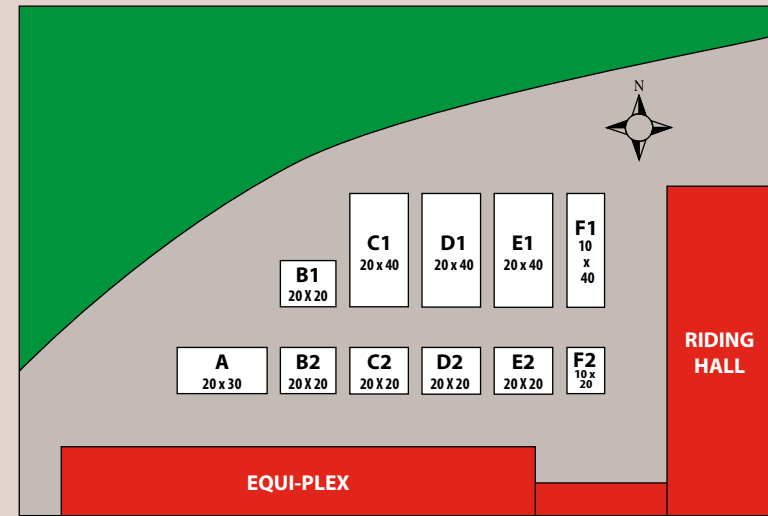

FOUNDERS PLAZA HÖCKER TENT • \$3,300

Unveiled in 2015 to celebrate the 40th Anniversary of Spruce Meadows, this centrally located plaza provides the public with an area to shop, eat and watch the many daily events.

With life sized bronzes of Mr & Mrs Southern (the founders of Spruce Meadows) as its focal point, Founders Plaza offers 5 Höcker Pavilions for rent during each of the Spruce Meadows events.

Prices do not include administration fee and 5% G.S.T.

'MASTERS' • SEPTEMBER 5-9, 2018 EQUI-FAIR and the SHOPS



'MASTERS' • SEPTEMBER 5-9, 2018 EQUI-FAIR and the SHOPS

RETURNING VENDOR:

Booth renewal & payment deadline to retain SAME booth space from last year is **March 16.**

NEW VENDOR:

Applications for new vendors may be submitted online at any time prior to the event - subject to booth availability and product suitability.

BOOTH CANCELLATION DEADLINE

To receive a full refund of 'Masters' booth fees, minus \$100 admin fee, booth must be cancelled no later than **July 20.** No refund of fees if cancelled after this date.

'MASTERS' MARKET MOVE IN / SET-UP/ HOURS

LARGE ITEM MOVE-IN

Friday, August 31 • 9:00am - 5:00pm

MOVE-IN & SET-UP

Monday, Sept. 3 • 9:00am - 5:00pm

Tuesday, Sept. 4 • 9:00am - 8:00pm

EXHIBIT HOURS

Wednesday, Sept. 5 • 11:00am - 5:30pm

Thursday, Sept. 6 • 11:00am - 5:30pm

Friday, Sept. 7 • 11:00am - 8:00pm

Saturday, Sept. 8 • 10:00am - 6:30pm

Sunday, Sept. 9 • 10:00am - 6:00pm

'MASTERS' MARKET DATES: SEPTEMBER 5-9, 2018

EXHIBIT OFFICE HOURS

Monday, Sept. 3 • 9:00am - 5:00pm

Tuesday, Sept. 4 • 9:00am - 8:00pm

Wednesday, Sept. 5 • 10:00am - 6:00pm

Thursday, Sept. 6 • 10:00am - 6:00pm

Friday, Sept. 7 • 10:00am - 8:30pm

Saturday, Sept. 8 • 9:00am - 7:00pm

Sunday, Sept. 9 • 9:00am - 6:30pm

MOVE-OUT

Sunday, July 9 • 6:00pm - 10:00pm

*No vehicles on grounds until public have left.
Approximately 6:30 pm*

SECURITY ON DUTY

Security is operational during closed hours only. No building security on-duty on Sunday after 10:00 am.

QUESTIONS?

CONTACT INFO:

Nickola: 403.974.4249 | Lisa: 403.974.4263

E-mail: exhibit.programs@sprucemeadows.com

Website: www.sprucemeadows.com/exhibitor

Fax: 403.974.4266

